

# Kanten und Frontrahmenprofile

## Edges and front frame profiles



### Sichtbar zurückhaltend.

Schützen und schmücken – elegante schlanke Rahmenprofile und Eckverbinder verbergen eventuelle Gehrungsversätze an den Frontkanten und setzen gleichzeitig dezente optische Akzente.

### Visibly reserved.

Protect and enhance – elegant, narrow frame profiles and corner cleats hide any misaligned mitres on the front edges, while also adding subtle visual accents.

iii	Vorteile	Benefits
	<ul style="list-style-type: none"> <li>▪ Attraktive Kantenabdeckung</li> <li>▪ Schmale Ansichtsflächen</li> <li>▪ Eckverbinder schließen Gehrungsversätze aus</li> </ul>	<ul style="list-style-type: none"> <li>▪ Attractive edge cover</li> <li>▪ Narrow face widths</li> <li>▪ Corner cleats to avoid misaligned mitres</li> </ul>

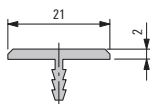

Profil 901 199  
Profile 901 199

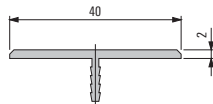

Profil 901 192  
Profile 901 192

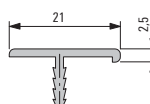

Profil 901 193  
Profile 901 193

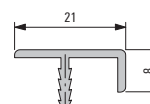

Profil 901 194  
Profile 901 194

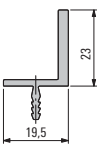

Profil 980 010  
Profile 980 010

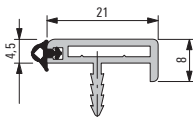

Profil 902 360 inkl. Dichtung  
551 627  
Profile 902 360 incl. gasket  
551 627

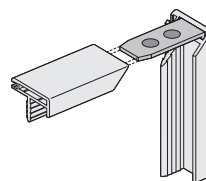

Eckverbinder für Profil 902 360  
550 544  
Corner cleat for profile 902 360  
550 544