

# Schüco Interior Openstyle interior design system

Structural and dynamic applications for  
infill material with a thickness of 16 or 19 mm



**SCHÜCO**



# Enquiry form for Schüco Interior Openstyle Structural design

**SCHÜCO**

Width of unit

 mm

Height of unit

 mm

Installation options:

Floor-to-ceiling with height compensation

Floor/wall, flat

Floor/wall, projecting

Wall or body, wall-mounted up to 40 kg

Wall or body with attachment rail, wall-mounted up to 80 kg

**See following page for restrictions**

Glazing bars:  Quantity (infill dividing, details per unit)

Enter axis dimensions for glazing bars. Inspection is carried out by the fabricator.

Supplied as ready-made frame profiles for on-site filling:

Design:  16 mm  19 mm

Sketch:

## Floor-to-ceiling with height compensation

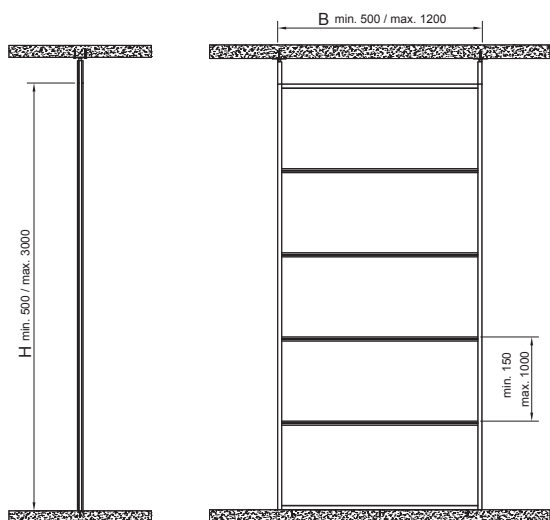

## Floor/wall, flat

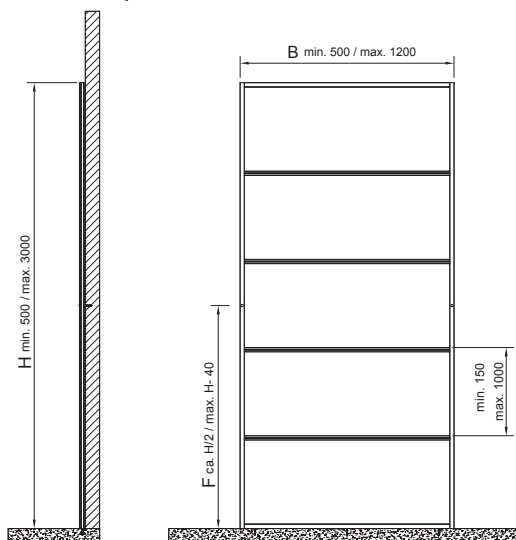

## Floor/wall, projecting

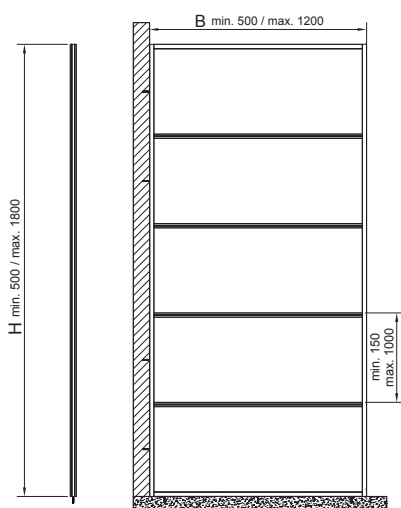

## Wall or body, wall-mounted up to 40 kg

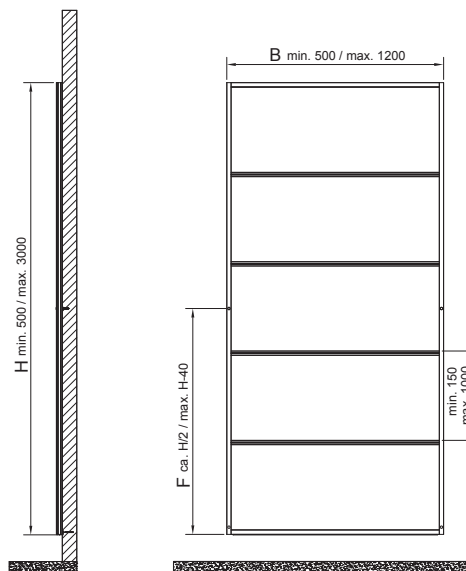

## Wall or body with attachment rail, wall-mounted for over 40 kg

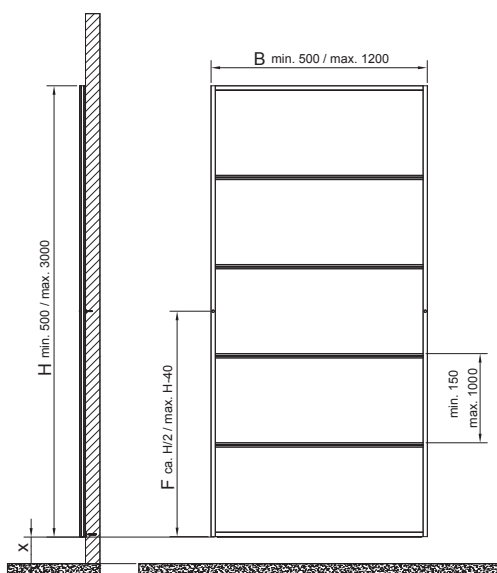

The system limits are described in the **installation instructions, Art. No. 100002281**. The load capacity of the system was determined based on tests carried out within the framework of the applicable regulations and standards from the furniture and kitchen industry. It requires compliance with all assembly steps described in detail. Deviations from the implemented specifications have effects on the stability of the shelving system. Exceeding the system limits is not covered by our tests and is your responsibility to validate. We will gladly provide you with the test results of the system we have developed for your analysis upon request.

**Please be sure to note:** The supplied fixing (anchor) is only suitable for concrete walls and solid building materials (for example, sand-lime brick). The installation materials must be checked by the installer for their suitability at the intended installation location.

# Enquiry form for Schüco Interior Openstyle Dynamic design

# SCHÜCO

## Room dimensions:

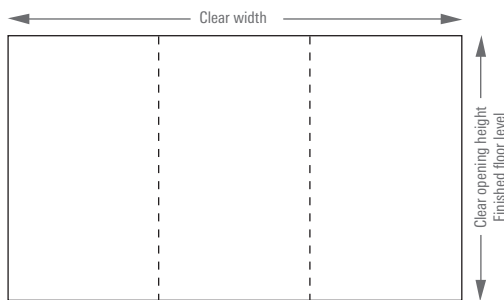

Clear width

Clear opening height

Glazing bar:  Quantity (infill dividing, details per unit)

Enter axis dimensions for glazing bars, the required number of glazing bars is based on door weight, door height and handle selection (handle deflection). Inspection is carried out by the fabricator.

## Supplied as ready-made frame profiles for on-site filling:

Design:  16 mm  19 mm

## Door leaf arrangement:

- 1-door**, floor and ceiling rail, single track
- 2-door**, floor and ceiling rail, double track
- 3-door**, floor and ceiling rail, double track
- 3-door**, floor and ceiling rail, triple track
- 4-door**, floor and ceiling rail, double track
- Custom arrangement** (please sketch on the extra page)

## Door damping:

Closing mechanism with dampened self closure. (Please enter quantity)

<input type="text"/>	Quantity	<input type="text"/>	Quantity	<input type="text"/>	Quantity
Damping set left		Damping set centre		Damping set right	

Please mark in the sketches as in the example.

Please mark the absorber with an **X** (example)

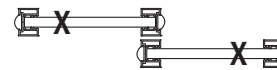

Please mark the medium absorber with an **X** (example)



**See following page for restrictions**

Length of ceiling guide track:  mm

Length of floor guide track:  mm

Handle profiles: Art. No.  Floor guide tracks: Art. No.  Ceiling guide tracks: Art. No.

## Ceiling and floor rail accessories:

**Cover plate track** for spaces between the double- and triple-track floor guide track

Ceiling guide rail for wall mounting with wall mounting bracket for **ceiling rail**

End caps for ceiling rail:  Quantity

## Sliding door arrangement



In front of the wall



Between a wall

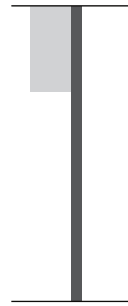

Ceiling installation

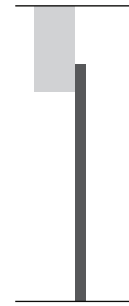

Wall-mounted installation

- **Max. system size 8400 mm** (7 doors, each 1200 mm)
- **Max. door width 1200 mm**
- **Max. unit height 3000 mm**
- **Total weight up to 80 kg**
- **Number of glazing bars (from 2.0 m, 1 x glazing bar recommended)**
  
- **Min. door widths**
  - 540 mm with self closure
  - 650 mm for centre damper
  - 940 mm with two self-closings

The system limits are described in the **installation instructions, Art. No. 100002280**.

The load capacity of the system was determined based on tests carried out within the framework of the applicable regulations and standards from the furniture and kitchen industry. It requires compliance with all the assembly steps described in detail. Deviations from the implemented specifications have an impact on the stability of the shelving system. Exceeding the system limits is not covered by our tests and is your responsibility to validate. We will gladly provide you with the test results of the system we have developed for your analysis upon request.

**Please be sure to note:** The supplied fixing (anchor) is only suitable for concrete walls and solid building materials (for example, sand-lime brick). The installation materials must be checked by the installer for their suitability at the intended installation location.

**Profiles for 16 and 19 mm infills**

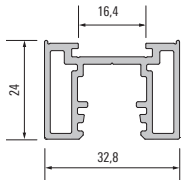

Handle profile 16

**100008659**

E6/EV1 aluminium  
5000 mm

**100008660**

E6/C35 black  
5000 mm

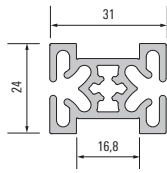

Glazing bar profile 16

**100008688**

E6/EV1 aluminium  
5000 mm

**100008689**

E6/C35 black  
5000 mm

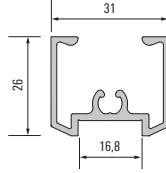

Frame profile 16  
top / bottom

**100008679**

E6/EV1 aluminium  
5000 mm

**100008680**

E6/C35 black  
5000 mm

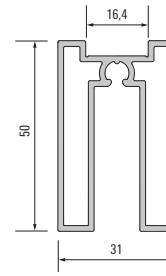

Frame profile 16  
bottom for roller fitting

**100008684**

E6/EV1 aluminium  
5000 mm

**100008685**

E6/C35 black  
5000 mm

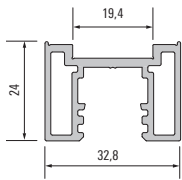

Handle profile 19

**100008732**

E6/C35 black  
5000 mm

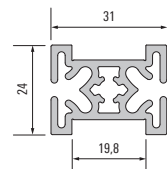

Glazing bar profile 19

**100008724**

E6/C35 black  
5000 mm

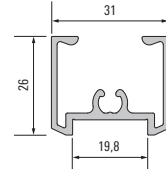

Frame profile 19  
top / bottom

**100008713**

E6/C35 black  
5000 mm

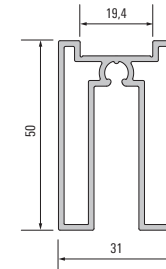

Frame profile 19  
bottom for roller fitting

**100008720**

E6/C35 black  
5000 mm

**Accessory profiles**

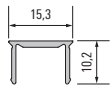

Groove cover profile

**100008666**

E6/EV1 aluminium  
5000 mm

**100008667**

E6/C35 black  
5000 mm

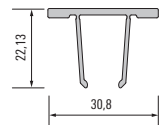

Cover profile

**100008739**

E6/C35 black  
5000 mm

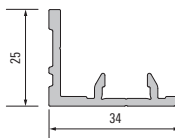

Attachment rail

**100008701**

E6/C35 black  
5000 mm

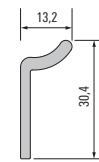

Assembly rail  
Accessories for  
recessed area

**100008710**

E6/C35 black  
5000 mm

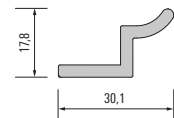

Assembly rail

**100008674**

E6/EV1 aluminium  
5000 mm

**100008675**

E6/C35 black  
5000 mm

## Ceiling guide tracks

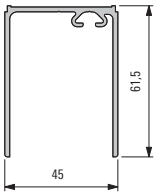

Guide track 61  
single track  
**100008354**  
E6/EV1 aluminium  
6000 mm  
**100022633**  
E6/C35 black  
6000 mm

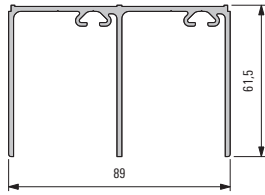

Guide track 61  
double track  
**100008351**  
E6/EV1 aluminium  
6000 mm  
**100008352**  
E6/C35 black  
6000 mm

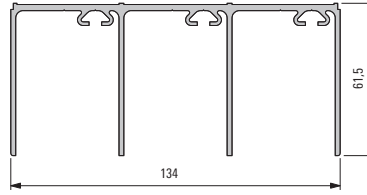

Guide track 61  
triple track  
**100008341**  
E6/EV1 aluminium  
6000 mm  
**100022573**  
E6/C35 black  
6000 mm

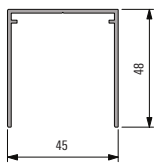

Guide track 48  
single track  
**100008398**  
E6/EV1 aluminium  
5500 mm

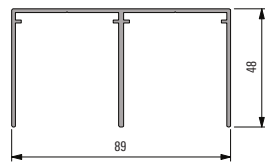

Guide track 48  
double track  
**100008388**  
E6/EV1 aluminium  
6000 mm

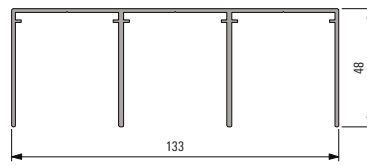

Guide track 48  
triple track  
**100008394**  
E6/EV1 aluminium  
6000 mm

## Surface-mounted floor rails

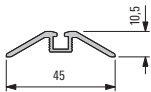

Insert for floor rail,  
surface-mounted  
**100008335**  
E6/EV1 aluminium  
6000 mm

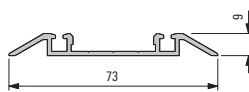

Double track  
surface-mounted  
**100008332**  
E6/EV1 aluminium  
6000 mm  
**100008333**  
E6/C35 black  
6000 mm

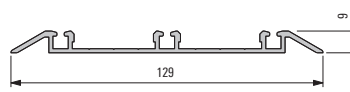

Triple track  
surface-mounted  
**100008343**  
E6/EV1 aluminium  
6000 mm  
**100008342**  
E6/C35 black  
6000 mm

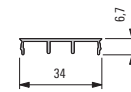

Cover plate track  
**100008326**  
E6/EV1 aluminium  
6000 mm  
**100008327**  
E6/C35 black  
6000 mm

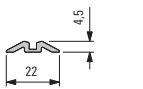

Single track,  
flat  
**100008348**  
E6/EV1 aluminium  
6000 mm  
**100008349**  
E6/C35 black  
6000 mm

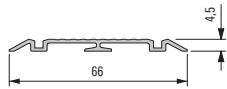

Double track,  
flat  
**100008361**  
E6/EV1 aluminium  
6000 mm  
**100008362**  
E6/C35 black  
6000 mm

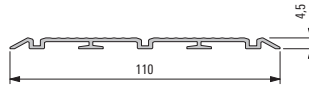

Triple track  
flat  
**100008384**  
E6/EV1 aluminium  
6000 mm  
**100008385**  
E6/C35 black  
6000 mm

## Floor rails, recessed, with joint covers



Insert for floor rail  
recessed  
**100008321**  
E6/EV1 aluminium  
6000 mm  
**100008322**  
E6/C35 black  
6000 mm

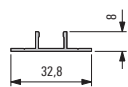

Load-bearing profile for  
single-track floor rail  
**100008329**  
E6/EV1 aluminium  
6000 mm

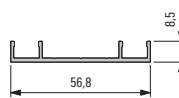

Load-bearing profile for  
double-track  
floor rail  
**100008338**  
E6/EV1 aluminium  
6000 mm